

## EnergiePlus comfort

THE HOMOGENEOUS PLASTER BASE BOARD  
FOR TIMBER FRAME CONSTRUCTION.

*The homogeneous plaster base board for composite thermal insulation systems (CTIS) in timber frame constructions, CTIS EnergiePlus comfort, manufactured using an innovative dry process. Fitted with tongue and groove, plaster base boards are mounted full surface directly onto the timber studs.*

### IHRE DÄMMVORTEILE AUF EINEN BLICK:

- Manufactured using a modern dry process
- Plasterable surface
- Low thermal conductivity
- All-round symmetrical tongue and groove
- High compressive strength
- Hydrophobic throughout
- Vapour permeable
- National technical approval

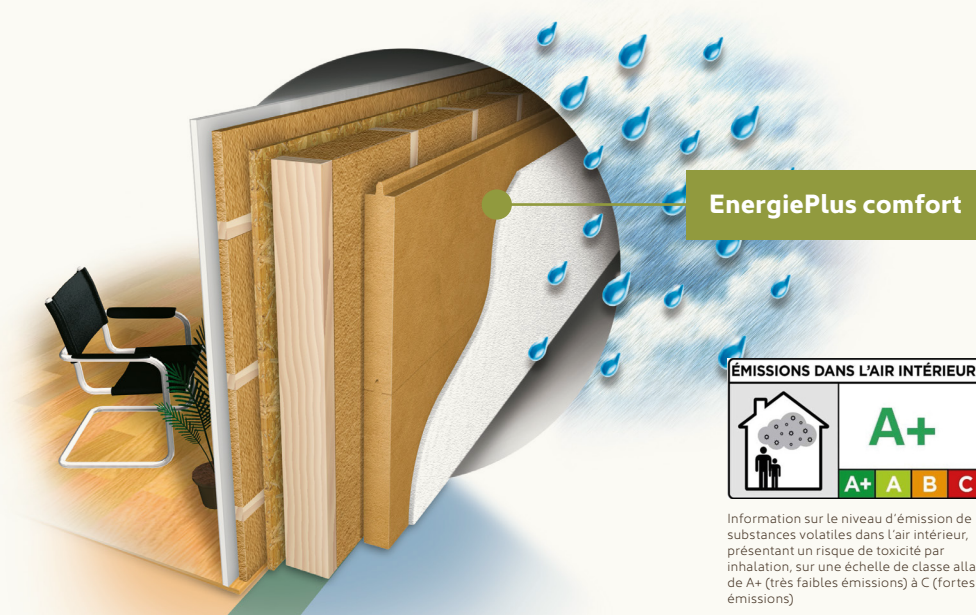

## APPLICATIONS

- Types of application in accordance with DIN 4108-10: WABds, WAPzh, WH, WLzg
- Plaster base board for composite thermal insulation systems (e.g. CTIS EnergiePlus comfort) in timber frame construction

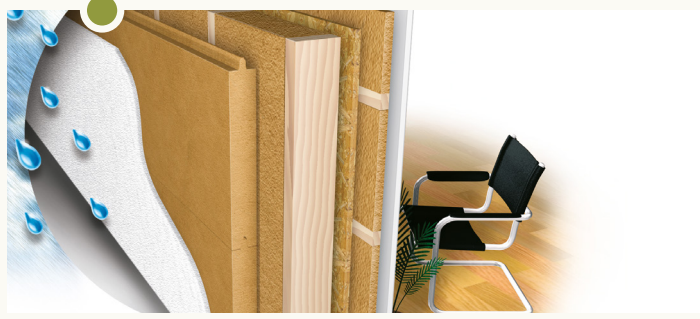

The plaster base board is designed specifically for use in timber frame construction, in respect of format, rigidity and hydrophobic property. It may therefore be mounted directly on the wall studs, creating a perfect and stable substrate for plastering.

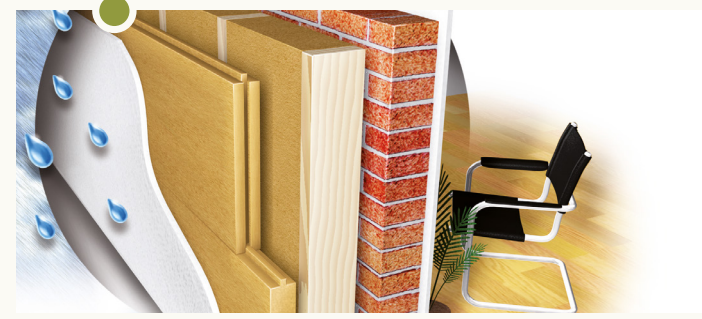

Thermal bridges are largely avoided. Thicknesses up to 160 mm assure outstanding thermal protection in a single work step.

## TECHNICAL DATA

Description	Wood fibre insulation board WF-EN13171-T4-TR20-CS(10/Y)100-WS1.0-MU3-AFr100
National technical approval (DIBt)	Z-23.15-1417 Plaster base board Z-33.47-905 CTIS EnergiePlus comfort
Complete declaration	Wood fibres, PMDI bonding 4 %, paraffin 1 %
Manufacturing process	Dry process
Specific heat capacity	2100 J/(kg·K)
Raw density (ca.)	185 kg/m <sup>3</sup>
Compressive stress at 10 % deformation	≥ 100 kPa
Tensile strength perpendicular to the plane of the board	≥ 20 kPa
Water vapour diffusion resistance factor μ	3
Thermal conductivity	up to 60 mm: $\lambda_D = 0,043 \text{ W/(mK) [EU]}$ $\lambda_D \text{ gem. SIA 279} = 0,044 \text{ W/(mK) [CH]}$ thick: $\lambda_R = 0,046 \text{ W/(mK) [DE]}$ $\lambda_Y = 0,047 \text{ W/(mK) [AT]}$  up to 80 mm: $\lambda_D = 0,039 \text{ W/(mK) [EU]}$ $\lambda_D \text{ gem. SIA 279} = 0,040 \text{ W/(mK) [CH]}$ thick: $\lambda_R = 0,042 \text{ W/(mK) [DE]}$ $\lambda_Y = 0,043 \text{ W/(mK) [AT]}$

## TECHNICAL DATA

Flow resistance per meter	≥ 100 kPa·s/m <sup>2</sup>
Short-term water absorption	≤ 1,0 kg/m <sup>2</sup>
Fire protection	Euro class in accordance with EN 13501-1: E
Disposal code in acc. with AVV	030105, 170201
Approved plasters and accessories	Competent advice: Tel. +49 34651 416900 [DE, EU]

## FORMATE

Form of supply	Homogeneous boards
Edge profile	Tongue and groove
Thicknesses [mm]	22*, 40, 60, 80, 100, 120, 140, 160
Delivery and calculation dimension [mm]	1325 x 615
Coverage dimensions [mm]	1300 x 590

\* Laibungsplatten sind als Zubehör erhältlich.

## ANY QUESTIONS? USE THE FOLLOWING ADDRESSES FOR EXPERT ADVICE:

**HOMATHERM GmbH** · Ahornweg 1 · D-06536 Berga · **Hotline** +49 34651 41661 · **Fax** +49 34651 41639 · [info@homatherm.com](mailto:info@homatherm.com) · [www.homatherm.com](http://www.homatherm.com)  
**International Hotline** +44 844 8802478

**HOMATHERM®**

# Accessories

## TOOLS AND SYSTEM COMPONENTS FOR THE COMPOSITE THERMAL INSULATION SYSTEM (CTIS).

HOMATHERM® offers you many accessories for composite thermal insulation systems; they are flexible in their application to suit your needs, enabling professional processing of the plaster base board using suitable tools. We can offer you tools, dowels, base rails and system components, among other.

### ENERGIEPLUS SCREW PLUG (PLATE SCREWS)

Description	Screw length in mm	Insulation thickness in mm
Plate screw	80	40
Plate screw	100	60
Plate screw	120	80
Plate screw	140	100
Plate screw	160	120
Plate screw	180	140
Plate screw	200	160
Plate screw	220	180
Plate screw	240	200
Plate screw	260	220
Plate screw	280	240
Plate screw	300	260

### ENERGIEPLUS MASONRY PLUG (INSULATION ANCHORS)

Description	Screw length in mm	Insulation thickness in mm
Masonry plugs	115	80
Masonry plugs	135	100
Masonry plugs	155	120
Masonry plugs	175	140
Masonry plugs	195	160
Masonry plugs	215	180
Masonry plugs	235	200
Masonry plugs	255	220
Masonry plugs	275	240
Cover for masonry plug		

#### ANY QUESTIONS? USE THE FOLLOWING ADDRESSES FOR EXPERT ADVICE:

HOMATHERM GmbH · Ahornweg 1 · D-06536 Berga · **Hotline** +49 34651 41661 · **Fax** +49 34651 41639 · [info@homatherm.com](mailto:info@homatherm.com) · [www.homatherm.com](http://www.homatherm.com)  
**International Hotline** +44 844 8802478

**HOMATHERM®**

## BASE RAILS

Description	Screw length in mm	
Base rail	43 mm	2 m length, anodised aluminium
Base rail	63 mm	2 m length, anodised aluminium
Base rail	83 mm	2 m length, anodised aluminium
Base rail	103 mm	2 m length, anodised aluminium
Base rail	123 mm	2 m length, anodised aluminium
Base rail	143 mm	2 m length, anodised aluminium
Base rail	163 mm	2 m length, anodised aluminium
Base rail	183 mm	2 m length, anodised aluminium
Base rail	203 mm	2 m length, anodised aluminium
Base rail	223 mm	2 m length, anodised aluminium
Base rail	243 mm	2 m length, anodised aluminium
Angular rail	thermal isolation	2 m length, plastic
Base edge profile	thermal isolation	2,5 lfm/Stück
Base rail connector	30 mm	
Base rail corner profile	43 mm	length: 0,835 m
Base rail corner profile	63 mm	length: 0,835 m
Base rail corner profile	83 mm	length: 0,835 m
Base rail corner profile	103 mm	length: 0,835 m
Base rail corner profile	123 mm	length: 0,835 m
Base rail corner profile	143 mm	length: 0,835 m
Base rail corner profile	163 mm	length: 0,835 m

### More information:

[www.homatherm.com/energieplus-accessories](http://www.homatherm.com/energieplus-accessories)

## SYSTEM COMPONENTS (PLASTER CONNECTION PROFILES)

Description
EnergiePlus reinforcing fabric fine white, 4 x 4 mm neutral 1.10 m wide
EnergiePlus fabric corner protection 10 x 15 cm, white, 2.50 m long
EnergiePlus diagonal reinforcement
EnergiePlus fabric connection strip 1.40 m
EnergiePlus fabric connection strip 2.40 m
EnergiePlus plug-on profile with fabric 250 cm, VWS fabric ca. 125 mm
EnergiePlus joint sealing tape BG2 15/2 – 5, roll length: 18.0 m
EnergiePlus joint sealing tape BG2 15/5 – 12, roll length: 9.0 m
EnergiePlus joint sealer 290 ml/cartridge
EnergiePlus expansion gap profile 2.50 m
EnergiePlus plaster termination profile 2.40 m
EnergiePlus lintel corner angle
EnergiePlus friction bearing profile upper part 6 mm; 2.5 m
EnergiePlus friction bearing profile lower part 9 mm; 2.5 m
EnergiePlus metal sheet connection profile with fabric 2.50 m
EnergiePlus movement profile 2.50 m
EnergiePlus drip edge profile 2.0 m
EnergiePlus roof ventilation profile 2.5 m

## SYSTEM COMPONENTS (PLASTER COMPONENTS)

Description
EnergiePlus reinforcing compound (adhesive)
EnergiePlus plaster base white
EnergiePlus plaster base tinted
EnergiePlus splash water protection
EnergiePlus moulding plaster
EnergiePlus modelling plaster tinted
EnergiePlus insulation base white
EnergiePlus silicon resin plaster K 2 white
EnergiePlus silicon resin plaster K 2 tinted, colour class 1 no additive
EnergiePlus silicon resin plaster K 3 white
EnergiePlus silicon resin plaster K 3 tinted, colour class 1 no additive
EnergiePlus silicon resin plaster R 3 white (no stock product, delivery time on request)
EnergiePlus silicon resin plaster R 3 tinted, colour class 1 no additive
EnergiePlus mineral light plaster K 2 white
EnergiePlus mineral light plaster K 2 tinted, colour class 1 no additive
EnergiePlus mineral light plaster K 3 white
EnergiePlus mineral light plaster K 3 tinted, colour class 1 no additive
EnergiePlus mineral light plaster R 3 white (no stock product, delivery time on request)
EnergiePlus mineral light plaster R 3 tinted, colour class 1 no additive
EnergiePlus façade paint special white
EnergiePlus façade paint special tinted
EnergiePlus façade paint intense tinted
Additives, hues, plaster colour class 2
Additives, hues, plaster colour class 3
Additives, hues, colour class 4

### ANY QUESTIONS? USE THE FOLLOWING ADDRESSES FOR EXPERT ADVICE:

**HOMATHERM GmbH** · Ahornweg 1 · D-06536 Berga · **Hotline** +49 34651 41661 · **Fax** +49 34651 41639 · [info@homatherm.com](mailto:info@homatherm.com) · [www.homatherm.com](http://www.homatherm.com)  
**International Hotline** +44 844 8802478

**HOMATHERM®**